



Arrangements for the return to school 2021/22

Dear All,

I hope that you are now all feeling rested after having a summer break and I am writing to let you know about the arrangements for the opening of school, on **Wednesday 25th of August 2021**, in line with the new government guidelines and I am pleased to share the easing of restrictions in many areas.

Class Bubbles: As from the 25th of August, it will be **no longer** necessary to keep children in consistent groups. Therefore, children will no longer be restricted to 'zones' on the playground during break times and lunch, assemblies in the hall will resume as normal and we will no longer be required to have staggered start and finish times to the school day.

Face Coverings: Face coverings are no longer advised for pupils, staff and visitors. Face coverings are only expected and recommended when travelling to and from school.

Self-Isolation: From 16th August children under the age of 18 years and 6 months will no longer be required to self-isolate if they are a close contact. They are advised to take a PCR test.

[Stay at home: guidance for households with possible or confirmed coronavirus \(COVID-19\) infection - GOV.UK](https://www.gov.uk/guidance/stay-at-home-guidance-for-households-with-possible-or-confirmed-coronavirus-covid-19-infection)
(www.gov.uk)

Covid-19 Symptoms or positive Test: No one should come into school if they have symptoms (temperature/ new continuous cough/ loss or change to smell or test) or have had a positive test result. If a child develops any of these symptoms during school hours, however mild, they will need to be collected. Children may return to school once they are not displaying any COVID-19 symptoms or have received a negative PCR test.

Control Measures to prevent the spread of COVID-19 will remain in place. These will include: good hygiene routines (the continuation of washing and gelling hands throughout the day) at various points, maintaining scheduled cleaning of shared areas throughout the day and good ventilation.

Children will enter and exit the school via their designated doors from 8.45am and will exit school via their designated doors at 3.15pm. If you have children in both KS1 and KS2, please be reassured that a member of the team will stay with your children until they are collected.

The school gates will be locked at 9am and will open at 3pm. If you are late, for any reason, please register at the school office.

Class	Entry (From 8.45am) and Exit Point (3.15pm)
Foundation	Foundation Stage Class doors (KS1 Playground)
Year 1: Mrs Cartwright	Year 1 Class Door
Year 1/2 : Mrs Abel	KS1 Playground Door (Morning Entry: Between Foundations stage and Year 1 Classroom Evening Collection from Year 1/2 classroom Door - KS2 Playground)
Year 2: Miss Standish	KS1 Playground Door (Between Foundations stage and Year 1 Classroom)

Year 3: Mrs Darby	Year 3 Classroom/ Playground Door
Year 3/4: Mr Challoner	KS2 Playground Door (Back of the school)
Year 4/5: Mr Skye	KS2 Playground Door (Back of the school)
Year 5/6: Miss O'Gorman	KS2 Playground door (Side of school)
Year 6: Mrs Murray	Year 6 KS2 Playground Door (Side of School)

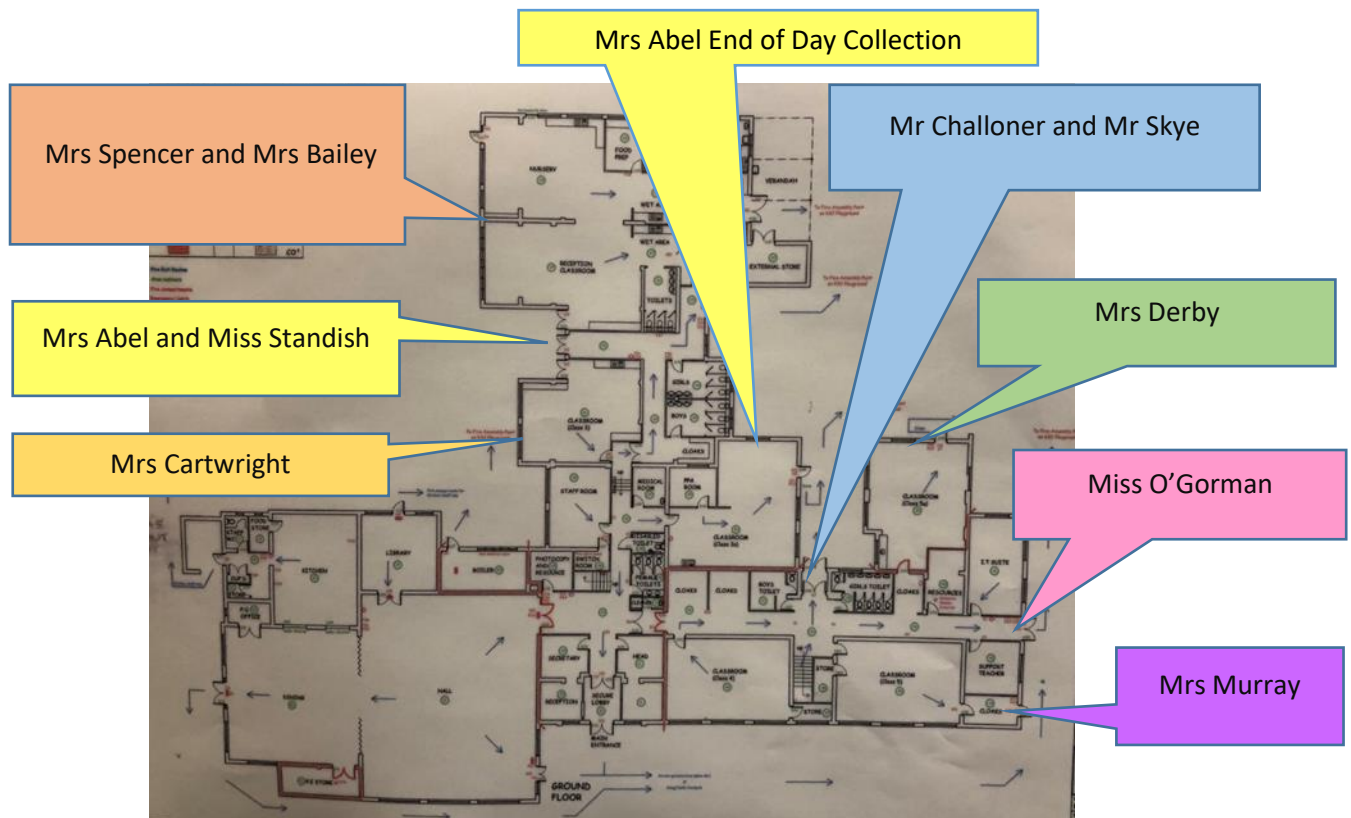

I am very much looking forward to welcoming everyone back to school and if you have any questions please contact the school.

Best Wishes

Mrs Clair Dedman
Head Teacher

St Joseph's Catholic Voluntary Academy
 WITH GOD'S GUIDANCE WE LOVE, LEARN, RESPECT AND FORGIVE
 Head Teacher: Mrs Clair Dedman
 Armadale Drive, Leicester, Leicestershire LE5 1HF
 Tel: 0116 241 6197
 Email: Office@st-josephs.leicester.sch.uk

